

www.appliedtek.co.in





COMPANY MISSION

↙ Applied Solutions:

Applied Technologies is supporting manufacturing companies in engineering to help for creating Innovative Products, Reduce Costs, and Shorten Development Cycles.

From initial concept to rapid production readiness, Applied Technologies provides Engineering Manufacturing & Design services for Defense, Automotive, Construction Equipment's manufactures, Sugar Plants, Industrial Equipment's and Machine Tool OEM's and suppliers.



COMPANY VISION

└ Provide Services:

Our vision is to emerge as a global leader in the construction equipment industry by combining innovation, reliability, and sustainability. We are committed to delivering high-performance, technology-driven solutions that enhance productivity, safety, and efficiency for our customers worldwide.

With a focus on continuous improvement and engineering excellence, we aim to empower infrastructure development and contribute to a more sustainable future. Through strong partnerships, superior service, and a passion for innovation, we strive to create lasting value for our customers, employees, and communities, positioning our brand as a trusted name in modern construction technology and equipment manufacturing.

COMPANY PROFILE

↙ Company Details:

Company Name: **APPLIED TECHNOLOGIES.**

ISO Certificate No: **305023082137Q**

Postal Address: **Plot No.29/4, D1 Block,
M.I.D.C. AKUDI INDUSTRIAL ESTATE,
AKURDI, Pune- 411 019**

GST No.: **ABKPL8329C1ZK**

ZED No.: **13052025_470695**

Phone / Telex: **+91 9922 83 7133, 9766 26 9444**

Company E-mail: **appliedtek@gmail.com**

Area: **5500 Sq.ft. R.C.C. Construction**

Power: **60 HP**

Our Bankers: **Union Bank Ltd.**

Turn Over: **6-8 Crore**

APPLIED TECH

Machine Set Up:

- VMC - HASS – MADE IN USA
- CNC TURNING CENTRE - JYOTI & HURON MACHINES + TSUGAMI CNC
- UNIVERSAL MILLING MACHINE - DU - FOUR – FRANCE 4 no's
- JIG BORING – TAIWAN
- LATHE –NORTON – 2 no's

- RADIAL DRILLING MACHINE – 1 no
- PRESS MACHINE – 1 no
- WELDING MACHINE MIG – 2 nos
- BEND SAW – 2 nos
- 8 H.P SCREW COMPRESSOR – 1 no

Company Workers:

ENGINEERS: 4 Nos

MACHINIST: 4 Nos

MILLER: 4 Nos

WELDER: 4 Nos

FITTER: 4 Nos

HELPER: 4 Nos

KEY CUSTOMERS

└ Brands We Worked:





↙ Providing
Services to
Following
OEM.



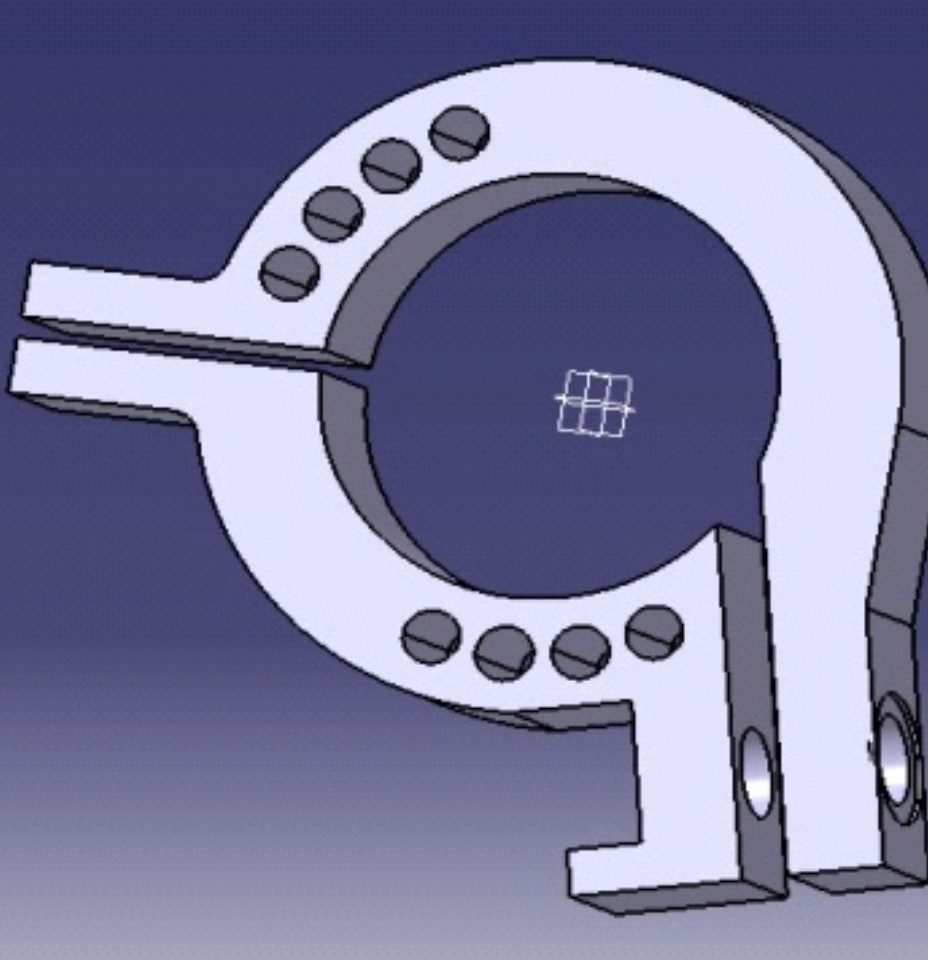

↙ Parts.

↙ Chassis Drilling Machine For Transit Mixer.

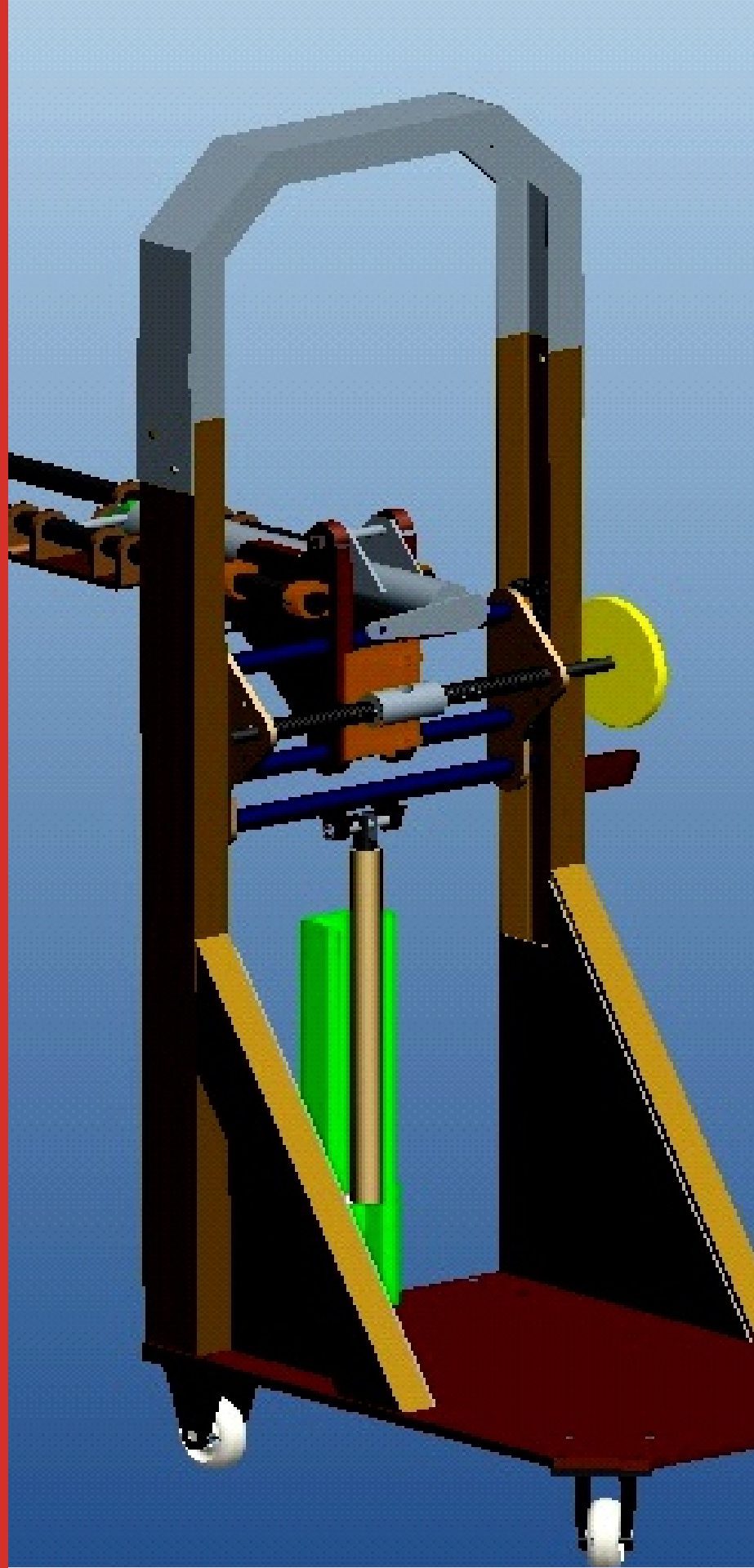

Concrete Boom Pump Parts.



↙ Tower
Crane Parts.



↙ Slipform Pavers Parts.



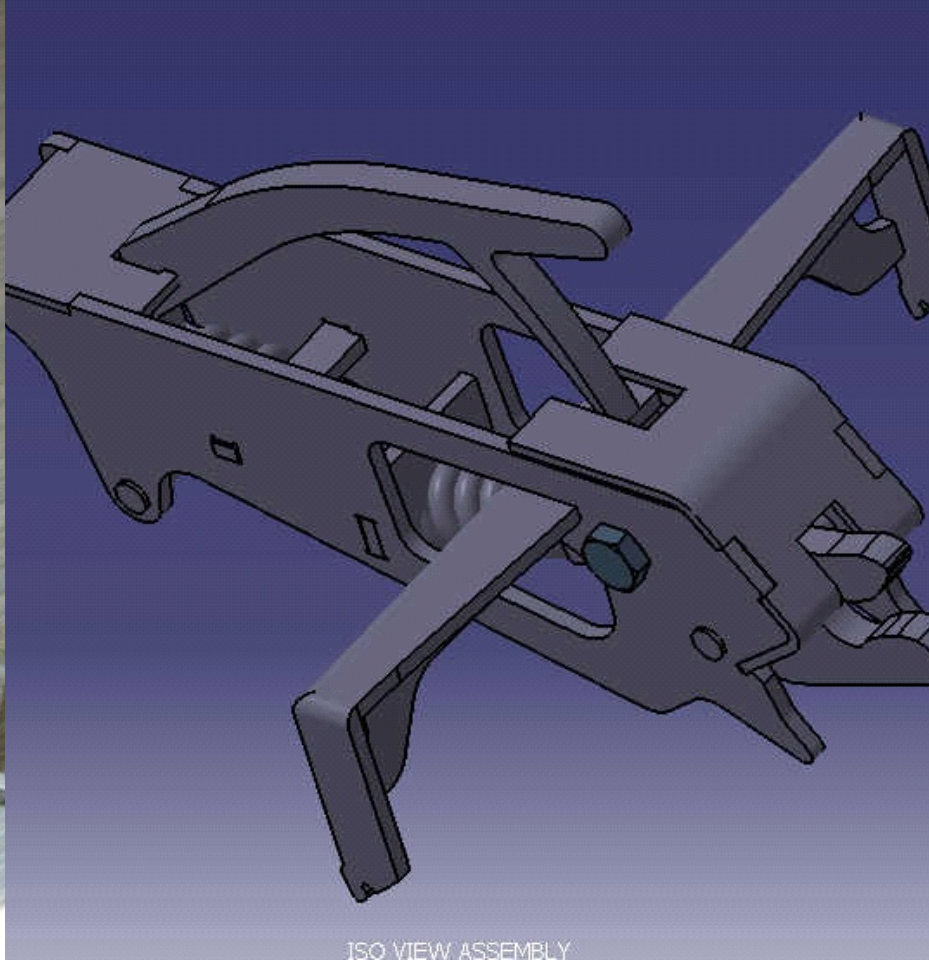
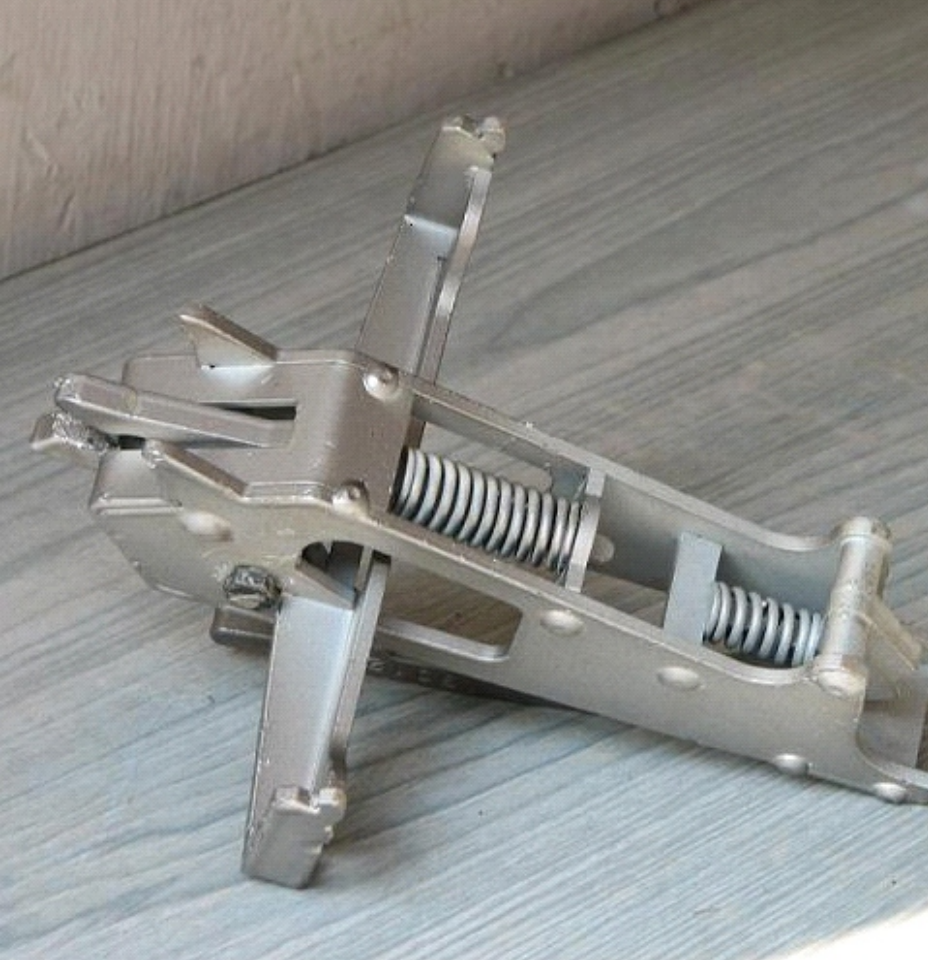

Applied Technologie Engineering



↙ Aerospace Parts



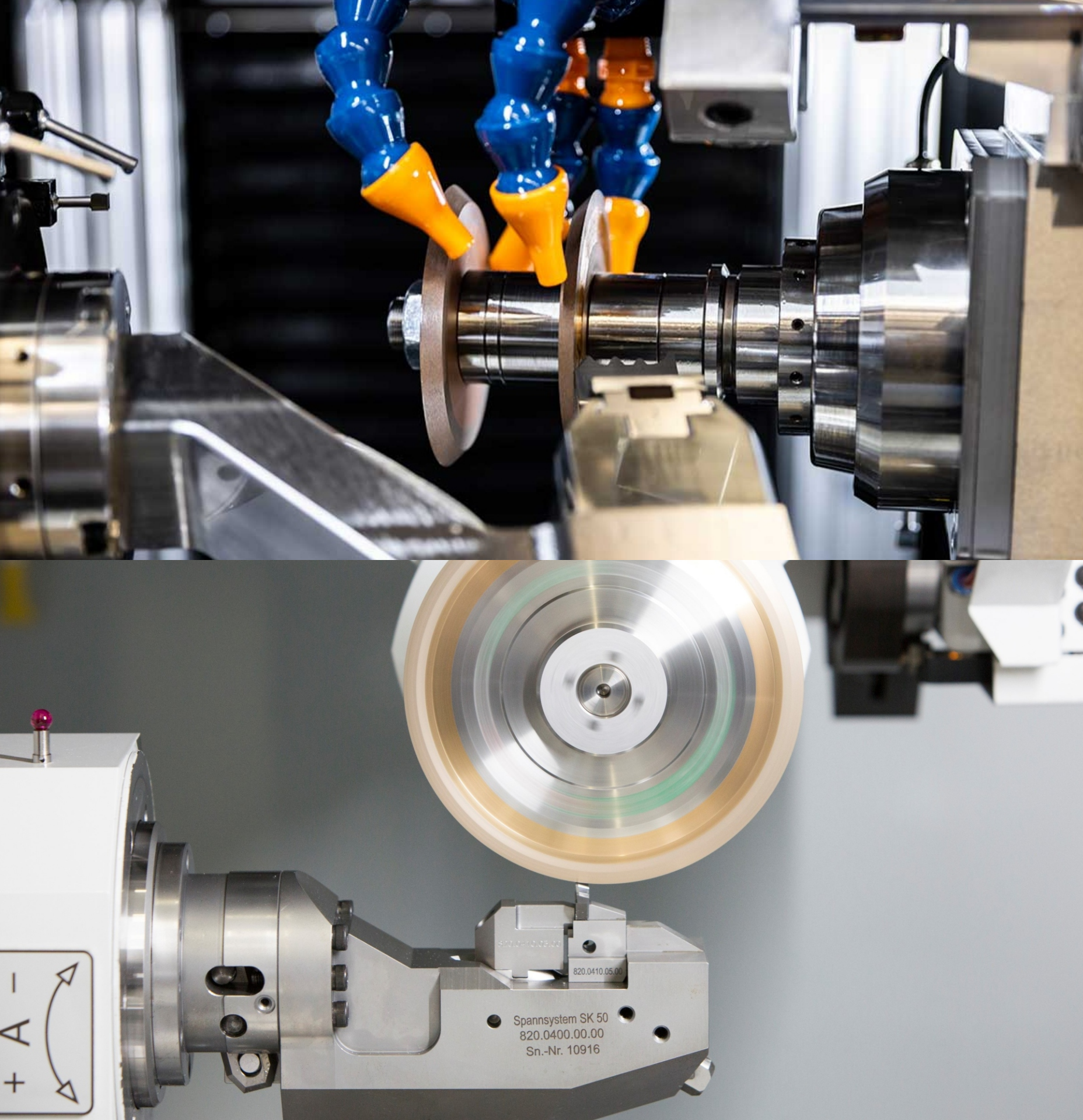

↙ CU Tip,
Dressing
Inserts.

Thank You

**APPLIED
TECHNOLOGIES**

Address:

Plot No. 29/4, 3B+3 Part,
Oppo Ador Welding, Akurdi Industrial Estate,
Akurdi, Pune - 411 019.

Proprietor: Abhijeet Londhe

Phone: +91 97 6626 9444 | E-mail: Abhijeet@appliedtechnologies.co.in

www.appliedteck.co.in